



## Installation Guide for 05-15 Toyota Tacoma LUXX-Series LED Tail lights

ALPHAREX specializes in designing and producing superior and uniquely stylish aftermarket automotive performance lighting with unrival innovative technology. The following installation guide we take you through the installation of your new **ALPHAREX TAIL LIGHTS** for your 05-15 Toyota Tacoma step by step.



### Table of Contents



#### PART I REMOVE TAIL LIGHTS

- **INSTALLATION TOOLS**
- **STEP 1.** Remove tail lights screws
- **STEP 2.** Unplug sockets and remove tail lights

#### PART II INSTALL ALPHAREX TAIL LIGHTS

- **STEP 1.** Plug the sockets and install tail lights
- **STEP 2.** Complete Installation

*Disclaimer: This installation article is a tutorial guide. By reading this article, you agree it is for reference only and AlphaRex USA and its distributors make no guarantee on the finished results. Under no circumstances whatsoever shall AlphaRex USA nor its distributors be liable for any damage, misuse or personal injuries. If you do not fully understand the installation procedure, it is highly recommended that you seek help from professional mechanics to do the installation.*

## PART I REMOVE TAIL LIGHTS

### INSTALLATION TOOLS

PREPARE THESE TOOLS FOR INSTALLATION

- 10 mm bolt socket
- Phillips screw driver
- Power wrench

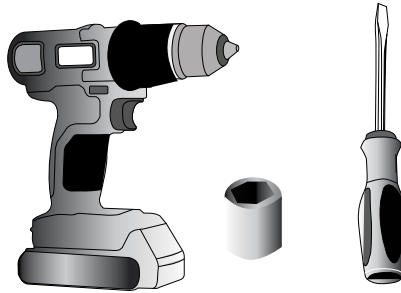

**NOTE:** Whenever using a power wrench, please make sure do not overtighten the screws.

Whenever working on your vehicle always make sure your vehicle is parked with the ignition off.





## STEP 1. REMOVE TAIL LIGHTS SCREWS

Open the trunk gate and start by removing the tail light's screws.

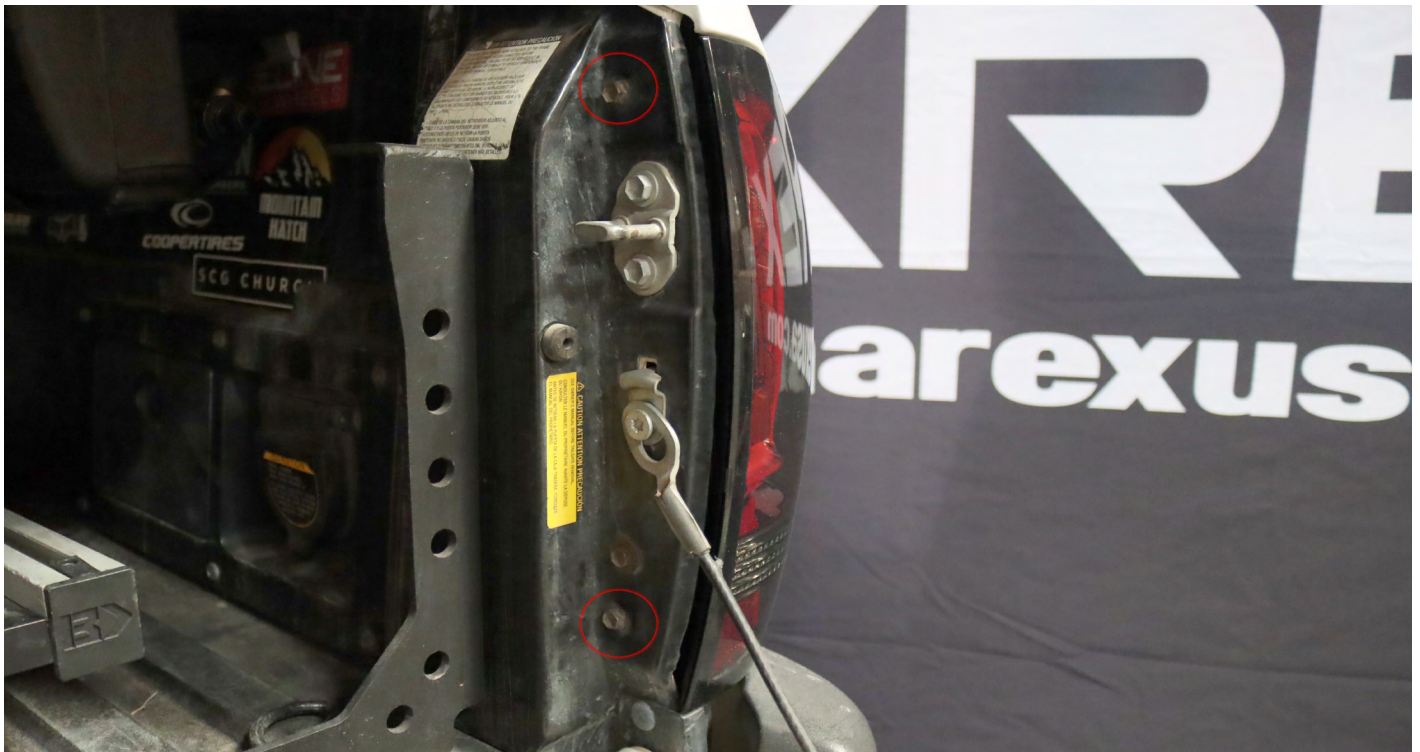

Remove the top and bottom 10mm screws from each side of the tail lights.





Gently remove the tail lights by pulling outward.

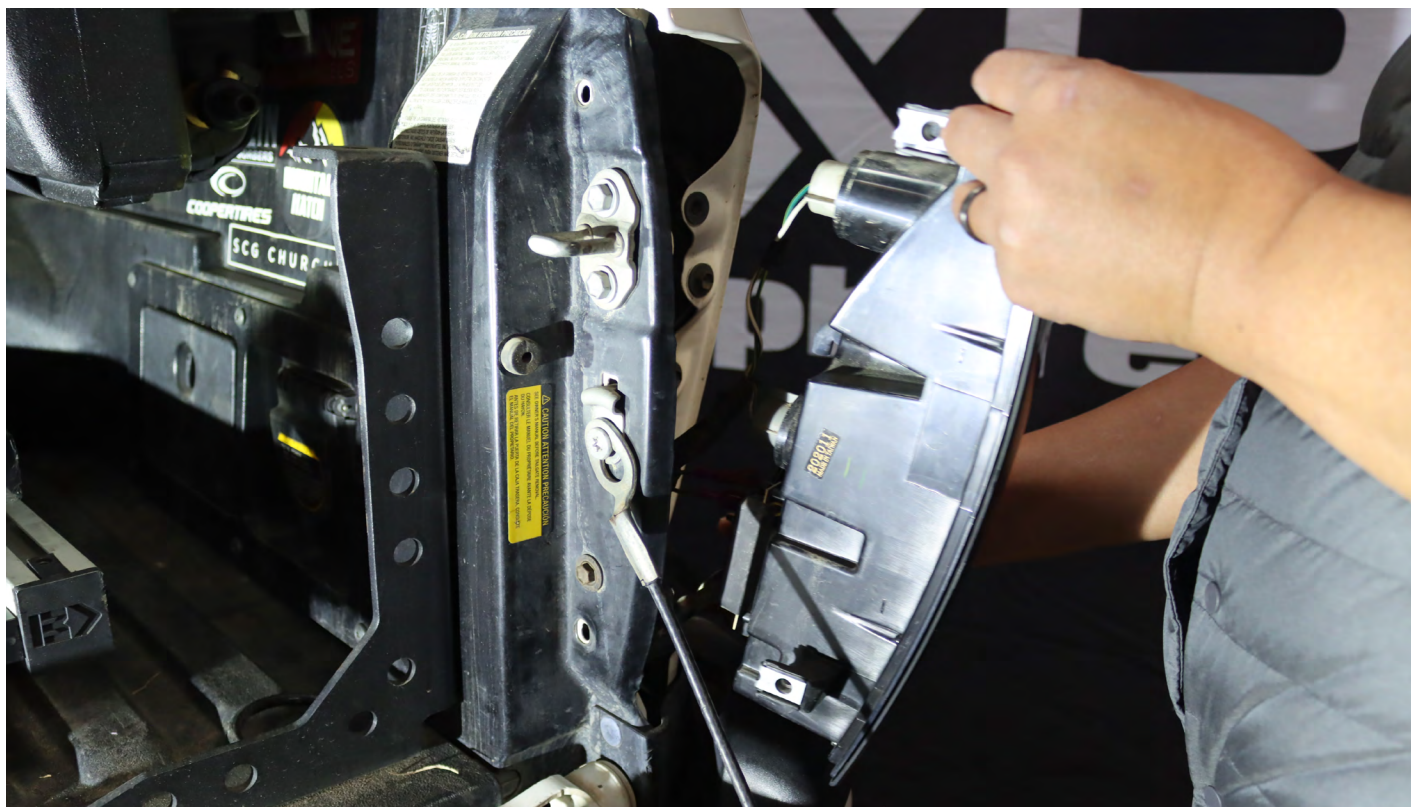

## STEP 2. UNPLUG SOCKETS AND REMOVE TAIL LIGHTS

When you have an enough space, unplug the sockets before removing the tail lights.





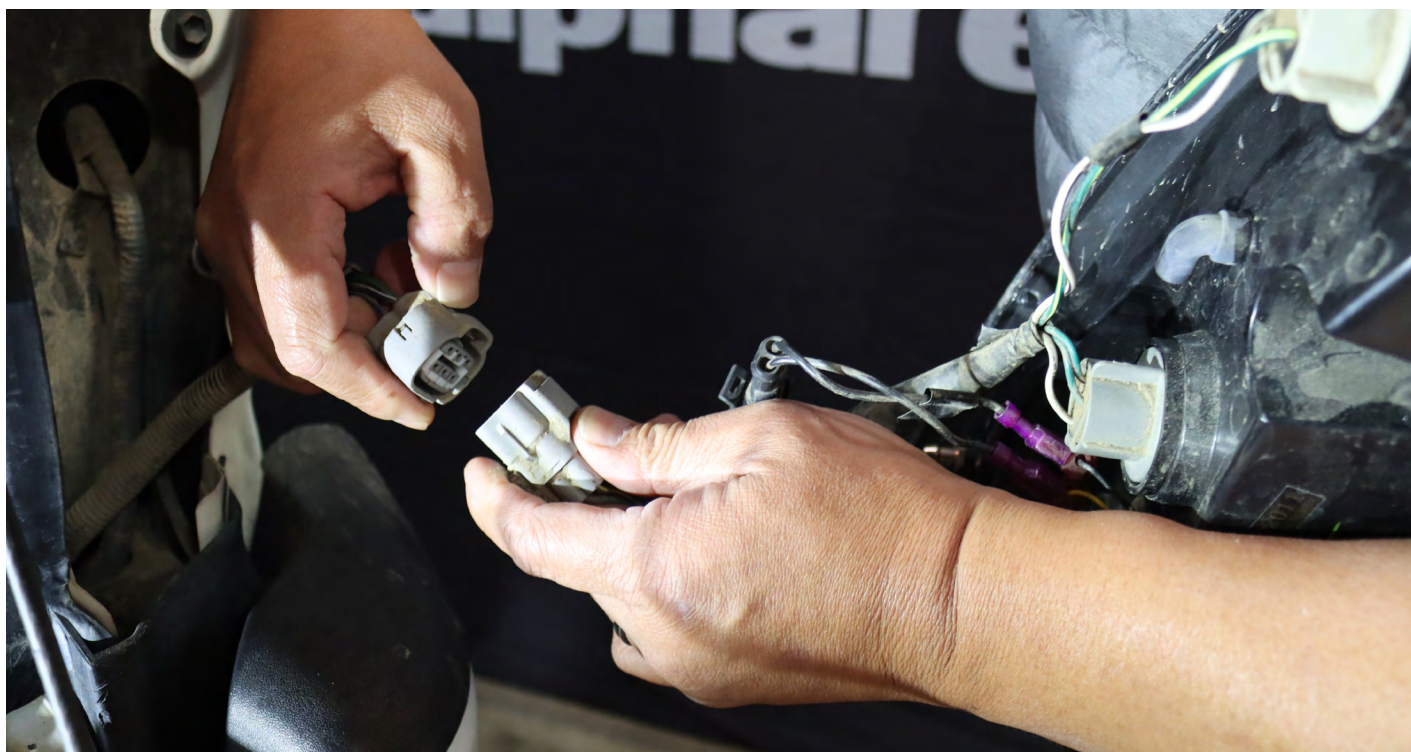

Repeat the steps for the other side to remove the tail lights completely.





## PART II    INSTALL ALPHAREX TAIL LIGHTS



### STEP 1. PLUG THE SOCKETS AND INSTALL TAIL LIGHTS

Plug the sockets directly to ALPHAREX tail lights.

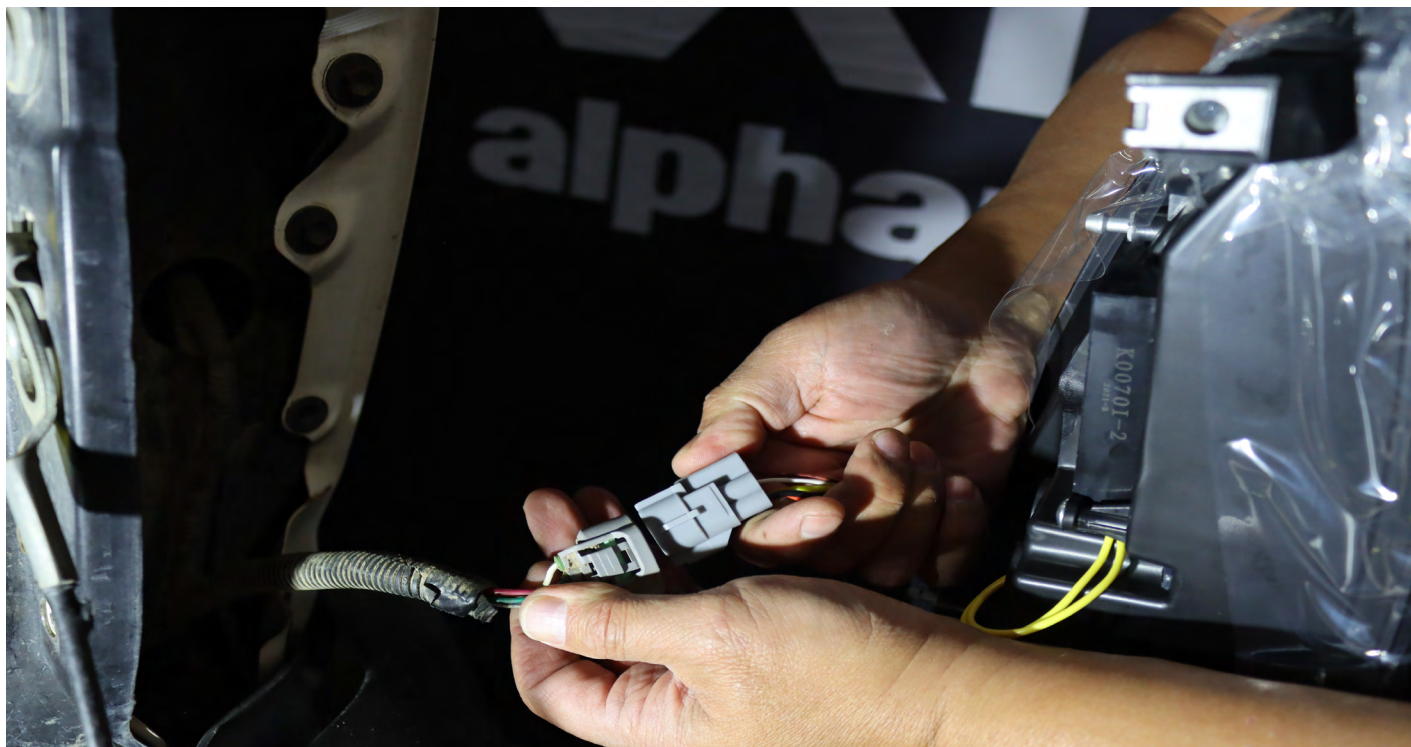



After the sockets are plugged into the new ALPHAREX tail lights, reverse the removal process to install the new tail lights into the vehicle.





Use Phillips screw driver to tighten the 2 X 10mm screws for each side.

**NOTE: Whenever using a power wrench, please make sure do not overtighten the screws.**

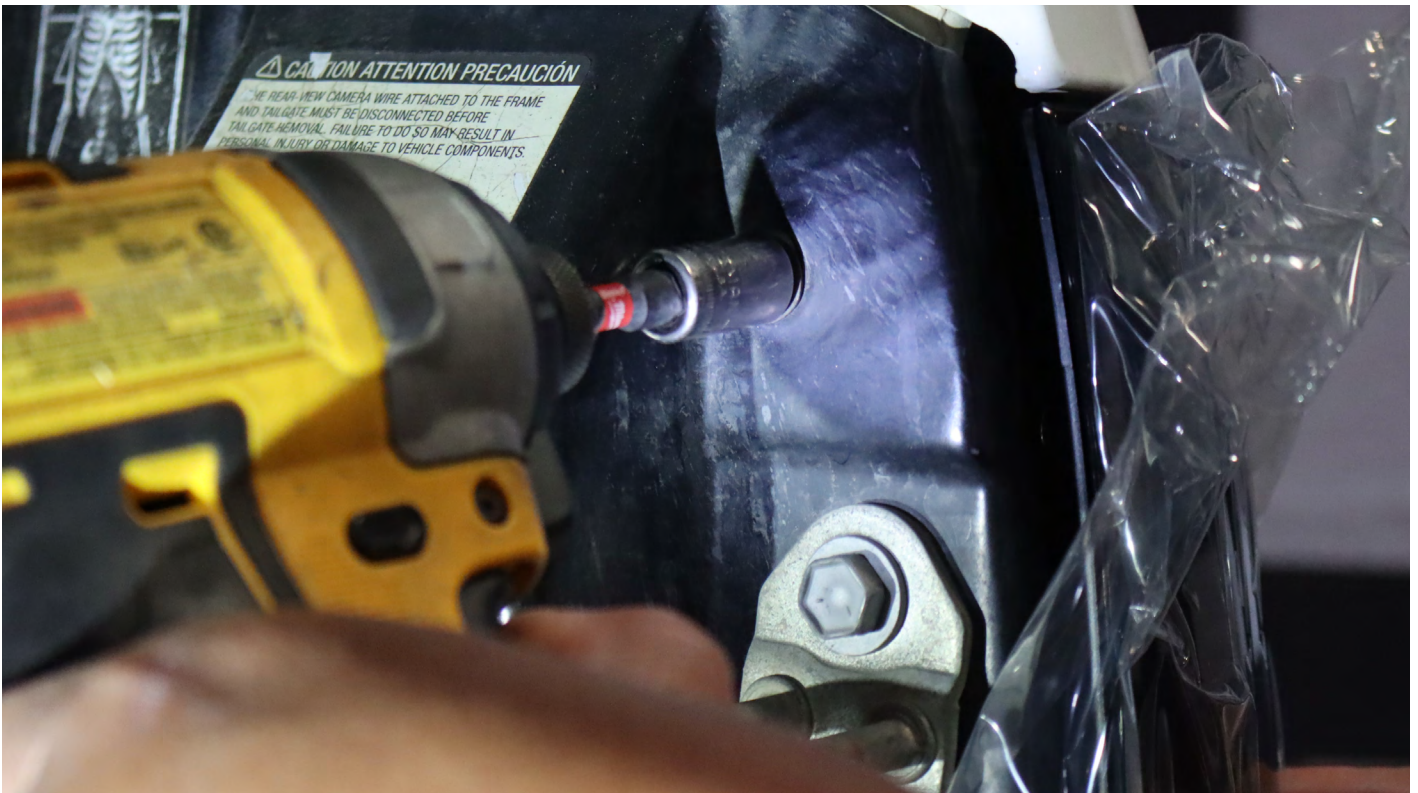



## STEP 2. COMPLETE INSTALLATION

Congratulations!  
you have completed the installation for ALPHAREX 05-15 Toyota Tacoma  
LUXX-Series LED tail lights.

